

PLOTTED: Aug 15, 2022 - 4:20pm

FILE: X:\projects\Agency\Gila County\BushFire\CAD\100Pct\Sycamore Creek\CO.dwg

SYCAMORE CREEK BANK PROTECTION PLANS
BUSH FIRE DRAINAGE IMPROVEMENT PROJECT
 EMERGENCY WATERSHED PROGRAM (EWP)
 IN COOPERATION WITH NATURAL RESOURCES CONSERVATION SERVICE
 GILA COUNTY PUBLIC WORKS DEPARTMENT, AZ

GENERAL DESCRIPTION OF PROJECT

CONSTRUCTION OF BANK PROTECTION ALONG RIVER RIGHT BANK OF SYCAMORE CREEK

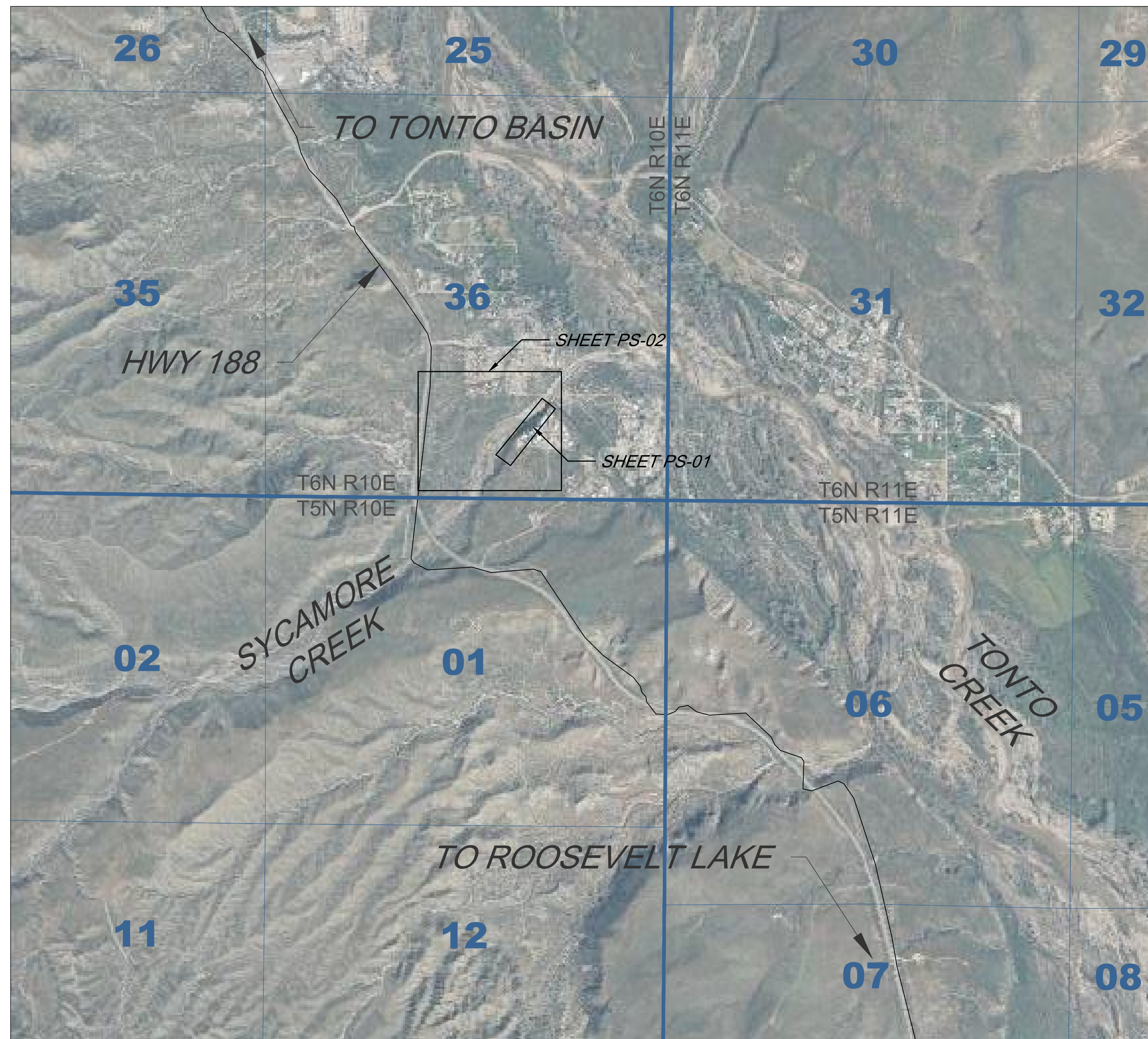

SYCAMORE CREEK PLAN VIEW

SCALE: 1" = 2,500'



LOCATION MAP

NOT TO SCALE



GILA COUNTY
PUBLIC WORKS DEPARTMENT

745 NORTH ROSE MOFFORD WAY
 GLOBE, ARIZONA 85501
 PHONE (928) 402-8530 FAX (928) 425-8104

GILA COUNTY BOARD OF SUPERVISORS

CHAIR **WOODY CLINE** DISTRICT 3
 VICE CHAIR **STEVE CHRISTENSEN** DISTRICT 1
 MEMBER **TIM R. HUMPHREY** DISTRICT 2

COUNTY MANAGER

JAMES MENLOVE

PUBLIC WORKS DEPARTMENT DIRECTOR

STEVE SANDERS

NRCS JOB CLASS

CLASS V

GENERAL NOTES

1. THE PARTICIPANT ASSURES THE USDA-NRCS THAT THE PROGRAM OR ACTIVITIES PROVIDED UNDER THIS AGREEMENT SHALL BE CONDUCTED IN COMPLIANCE WITH ALL LAWS, REGULATIONS, AND POLICIES FOR FEDERAL, STATE, AND LOCAL AGENCIES.
2. IT SHALL BE THE RESPONSIBILITY OF THE PARTICIPANT TO OBTAIN ALL NECESSARY CLEARANCES, PERMITS, RIGHTS OF WAY, AND EASEMENTS.
3. IT SHALL BE THE RESPONSIBILITY OF THE PARTICIPANT AND CONTRACTOR TO ENSURE THAT THE PROJECT IS CONSTRUCTED ACCORDING TO THE ATTACHED DRAWINGS, SPECIFICATIONS, AND SPECIAL REQUIREMENTS. ANY SIGNIFICANT CHANGES THAT AFFECT THE SCOPE OR COMPLEXITY OF THE PROJECT SHALL BE SUBMITTED, IN WRITING, TO THE NRCS THREE (3) WORKING DAYS PRIOR TO IMPLEMENTATION FOR APPROVAL.
4. ALL EXISTING CONDITIONS ARE TO BE VERIFIED IN THE FIELD PRIOR TO CONSTRUCTION. ANY ADJUSTMENTS FROM THE DRAWINGS ARE TO BE MADE AS DIRECTED BY THE AGENCY APPROVING OFFICIAL.
5. ALL STATIONING REFERS TO BASELINE OF CONSTRUCTION AND IS MEASURED HORIZONTAL DISTANCE. SURVEY POINTS ARE TIED TO LOCAL BENCHMARKS AND ARE NOT RELATED TO ANY KNOWN ESTABLISHED BENCHMARKS OR SURVEYED GRID SYSTEM.
6. NRCS SHALL BE NOTIFIED THREE (3) WORKING DAYS PRIOR TO CONSTRUCTION.

LOCATION OF UTILITIES

1. NRCS MAKES NO REPRESENTATION AS TO THE EXISTENCE OR NONEXISTENCE OF ANY UTILITIES, PUBLIC OR PRIVATE. THE CONTRACTOR IS RESPONSIBLE FOR CONTACTING AND COORDINATING THE WORK WITH ALL UTILITY COMPANIES.
2. CONTRACTOR SHALL CONTACT ARIZONA 811 EITHER BY PHONE OR ONLINE.
3. IT IS THE RESPONSIBILITY OF THE CONTRACTORS AND LANDOWNERS TO COMPLY WITH THE PROVISIONS OF ARIZONA STATE LAW. THE CONTRACTORS WILL BE RESPONSIBLE FOR ANY DAMAGE RESULTING FROM DISRUPTION OF SERVICE CAUSED BY CONSTRUCTION ACTIVITIES.

DRAWING NUMBER & SHEET INDEX

DRAWING NO.	SHEET NO.	TITLE
CO-01	1	COVER SHEET
NO-01	2	GENERAL NOTES
DT-01	3	TYPICAL SECTION DETAIL
PS-01	4	PLAN SHEET
PS-02	5	TEMPORARY ACCESS PLAN

PROJECT DATA

DESIGN EVENT:
 1. THIS DESIGN IS FOR A 100-YEAR POST-FIRE DISCHARGE ON SYCAMORE CREEK.
 Q100 = 12,148 CFS

ELEVATION DATA:
 1. THE ELEVATION DATUM FOR THIS PROJECT IS NAVD '88. LIDAR MAPPING WAS COMPLETED BY WOOLPERT IN FEBRUARY 2019.

2. BACKGROUND DATA AND LINWORK SHOWING EXISTING FEATURES WAS PROVIDED BY GILA COUNTY (JUNE 2021).

3. THE ENGINEER MAKES NO REPRESENTATION OR GUARANTEE REGARDING THE ACCURACY OF THE SURVEY DATA REFERENCED ON THE PLANS. THE CONTRACTOR SHALL VERIFY THE LOCATION OF EXISTING FEATURES, PROPERTY CORNERS, PROJECT BOUNDARIES, RIGHTS-OF-WAY AND TOPOGRAPHIC SURVEY DATA PRIOR TO COMMENCEMENT OF CONSTRUCTION. THE CONTRACTOR SHALL NOTIFY THE OWNER'S AGENT IMMEDIATELY OF ANY DISCREPANCIES FOR RESOLUTION.

SURVEY NOTE:
 1. THIS PLAN IS BASED ON TOPOGRAPHIC SURVEY DATA PROVIDED BY GILA COUNTY'S SURVEYING DIVISION. PARCEL LINE AND RIGHT OF WAY LINES WERE ESTABLISHED FROM GIS DATA PROVIDED BY GILA COUNTY. THE ENGINEER MAKES NO REPRESENTATION OR GUARANTEE REGARDING THE ACCURACY OF THE SURVEY DATA REFERENCED ON THE PLANS. THE CONTRACTOR SHALL VERIFY THE LOCATION OF EXISTING FEATURES, PROPERTY CORNERS, PROJECT BOUNDARIES, RIGHTS-OF-WAY AND TOPOGRAPHIC SURVEY DATA PRIOR TO COMMENCEMENT OF CONSTRUCTION. THE CONTRACTOR SHALL NOTIFY THE OWNER'S AGENT IMMEDIATELY OF ANY DISCREPANCIES FOR RESOLUTION.

EARTHWORK QUANTITIES
 1. NO PROJECT SPECIFIC GEOTECHNICAL INVESTIGATION HAS BEEN PERFORMED. ALL EARTHWORK IS CONSIDERED "UNCLASSIFIED."

*THE EXCAVATION AND EMBANKMENT QUANTITIES ON THESE PLANS ARE APPROXIMATE ONLY AND IS BASED ON COMPARING THE EXISTING GROUND TO THE PROPOSED FINISHED GROUND. NO EARTHWORK VOLUME ADJUSTMENTS WERE MADE DUE TO OVEREXCAVATION AND FOOTING CONSTRUCTION, UTILITY INSTALLATION, PAVEMENT AND SUBGRADE THICKNESS, RIPRAP THICKNESS, LANDSCAPE MATERIALS, ETC. NO ALLOWANCE HAS BEEN MADE FOR SHRINK OR SWELL.

ACKNOWLEDGEMENT

(Representative/Agent)
 I have reviewed the plans and specifications and understand my operation and maintenance responsibilities. I accept and approve them for the construction of this project.

SIGNATURE _____ DATE _____
 TITLE _____

AS-BUILT

Construction Information
 CONTRACTOR _____
 CONSTRUCTION COMPLETION DATE _____
 INSPECTOR _____

ACCEPTANCE

(Government Representative)
 NRCS accepts this practice(s) for certification
 SIGNATURE _____ DATE _____
 TITLE _____



DATE	REVISION	DESCRIPTION

8400 S. KYRENE RD.
 SUITE 201
 TEMPE, AZ 85284
 (480) 752-2124
 WWW.JEFULLER.COM

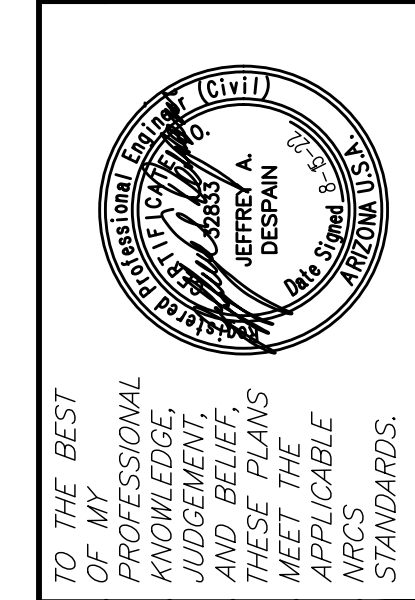

JOB NO: P3786.02	DATE: 8/15/2022	SCALE: B/D	DRAWN: JAD	DESIGN: JAD	CHECKED: JAD
------------------	-----------------	------------	------------	-------------	--------------

COVER SHEET

DRAWING NO. CO-01	
SHT NO. 1	OF 5

**SYCAMORE CREEK BANK PROTECTION PLANS
BUSH FIRE DRAINAGE IMPROVEMENTS PROJECT**

Contact Arizona 811 at least two full working days before you begin excavation

 Call 811 or click Arizona811.com

DATE	DESCRIPTION	REVISION

8400 S. KYRENE RD.
 SUITE 201
 TEMPE, AZ 85284
 (480) 752-2124
 WWW.JEFULLER.COM

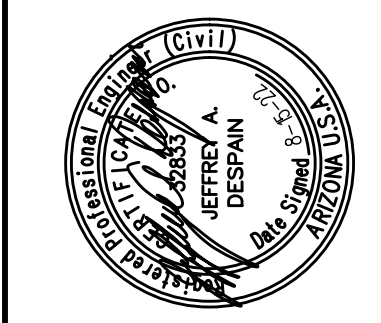
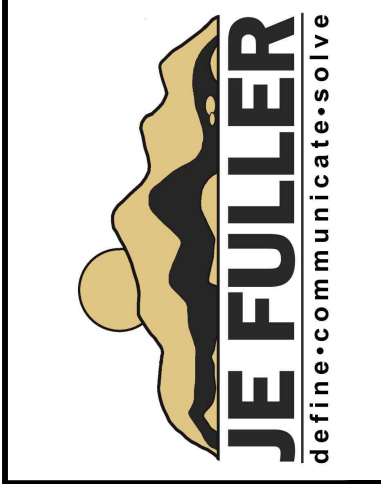

TO THE BEST OF MY PROFESSIONAL KNOWLEDGE, SKILL, AND BELIEF, THESE PLANS MEET THE APPLICABLE NRCS STANDARDS.

JOB NO:	P3786.02
DATE:	8/15/2022
SCALE:	B/D
DRAWN:	JAD
DESIGN:	JAD
CHECKED:	JAD

TYPICAL SECTION DETAIL

DRAWING NO.
DT-01

SHT NO.	OF
3	5

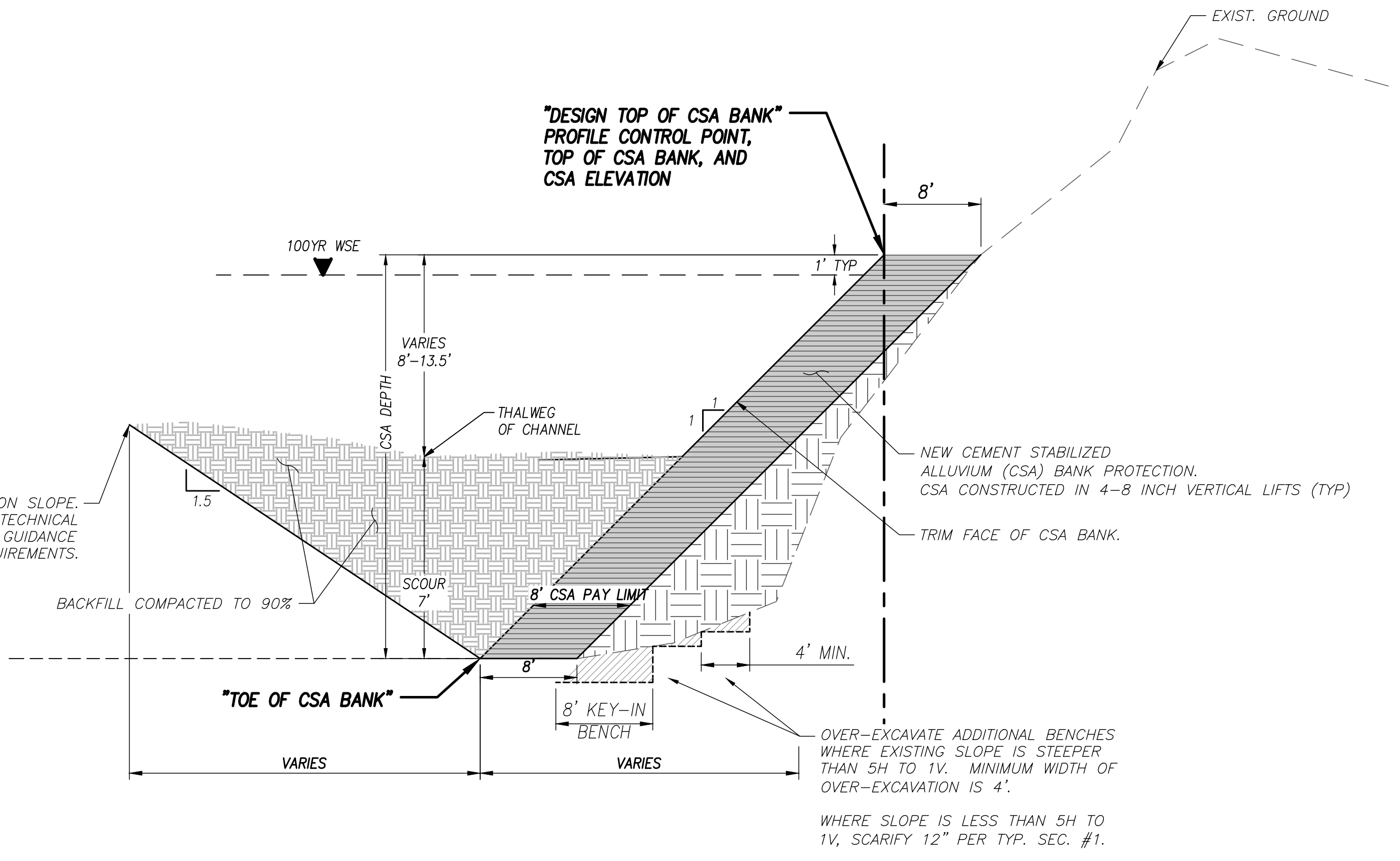

1 **CSA DETAIL**
 SCALE: NTS

PLOTTED: Aug 15, 2022 - 4:20pm

FILE: X:\projects\Agency\Gila County\BushFire\CAD\100Pct\Sycamore_Creek\DT.dwg

**SYCAMORE CREEK BANK PROTECTION PLANS
BUSH FIRE DRAINAGE IMPROVEMENTS PROJECT**

PLOTTED: Aug 15, 2022 - 4:23pm

FILE: X:\projects\Agency\Gila County\BushFire\CAD\100Pct\Sycamore_Creek\PS-02_ACCESS.dwg



© 2022 Microsoft Corporation © 2022 Maxar © CNES (2022) Distribution Airbus DS

REMOVE		UNIT	QTY
1	CLEAR AND GRUB EXISTING VEGETATION WITHIN LIMITS OF GRADING TEMPORARY ACCESS	AC	0.1
RELOCATE		UNIT	QTY
CONSTRUCT		UNIT	QTY

N

GRAPHIC SCALE 1" = 80'

80 0 80 160 240

REMOVE UNIT QTY
 RELOCATE UNIT QTY
 CONSTRUCT UNIT QTY

Contact Arizona 811 at least two full working days before you begin excavation
ARIZONA 811
 Call 811 or click Arizona811.com

DATE	DESCRIPTION	REVISION

8400 S KYRENE RD.
 SUITE 201
 TEMPE, AZ 85284
 (480) 752-2124
 WWW.JEFULLER.COM

JE FULLER
 define • communicate • solve

TO THE BEST OF MY PROFESSIONAL KNOWLEDGE, SKILL, AND BELIEF, THESE PLANS MEET THE APPLICABLE NRC STANDARDS.

JOB NO:	P3786.02
DATE:	8/15/2022
SCALE:	B/D
DRAWN:	JAD
DESIGN:	JAD
CHECKED:	JAD

TEMPORARY ACCESS PLAN

DRAWING NO.
PS-02

SHT NO.	OF
5	5