

1983

# RECORD OF SURVEY

OF THAT PARCEL DESCRIBED IN THE INSTRUMENT RECORDED IN DOCKET 849, PAGE 561 GILA COUNTY RECORDS.  
LOCATED IN THE SE 1/4 OF THE NE 1/4 OF SECTION 36, TOWNSHIP 12 NORTH, RANGE 8 EAST OF THE GILA  
AND SALT RIVER MERIDIAN, GILA COUNTY, ARIZONA.

FOR: SUE BOGLE  
P.O. BOX 38  
PINE, AZ. 85544



State of Arizona, County of Gila ss:  
I do hereby certify that the within instrument was  
filed and recorded at the request of Sue Bogle  
of North Star Surveying Inc  
Date 12-07-00 Time 10:05 AM Map No. 1983  
Official Records, Records of Gila County, Arizona WITNESS  
my hand and official seal the day and year first above written.  
Linda Haught Ortega  
County Recorder  
By Jacqueline Ducken, Deputy  
2000 16523

**APPROVED TO RECORD**  
DATE 12-07-00  
Jerry H. Smith  
GILA COUNTY COMMUNITY DEVELOPMENT DIVISION

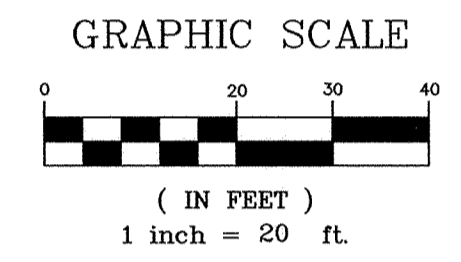

- LEGEND**
- (R) = RECORD INFORMATION PER DEED
  - (R\*) = RECORD PER PINE CREEK SUBDIVISION NO. 1 MAP 190 G.C.R.
  - (M) = MEASURED INFORMATION
  - = FOUND MONUMENT AS NOTED
  - = SET 1/2" REBAR W/BRASS TAG L.S.#23955
  - ☆ = LIGHT POLE
  - OH E = OVERHEAD ELECTRIC

- NOTES**
- The Westerly property line was established by using A.D.O.T. Right-Of-Way monuments referenced on Record of Survey Map No. 1846, 1846A and 1846B, G.C.R.
  - The South property line was established by using an A.D.O.T. Right-Of-Way monument at the Southwest Corner and intersecting the monumented deed line with the East-West Mid Section Line at the Southeast Corner.
  - The Boundaries were established using a deed recorded in Docket 849, Page 561 G.C.R., Pine Creek No. 1 Subdivision Map 190 G.C.R. and unrecorded right-of-way plans Payson-Flagstaff State Highway Project No. 5-209-603 Gila County.
  - ACREAGE = 18,538.63 SQ. FT., 0.43 ACRES

**CERTIFICATION**  
This is to certify that this map, consisting of one (1) sheet correctly represents a survey made under my supervision during the Month of NOVEMBER, 2000.

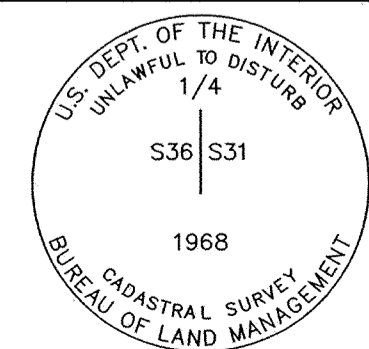
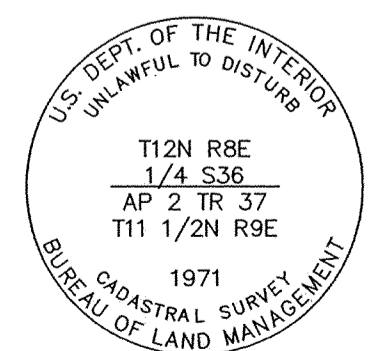

**NORTHSTAR SURVEYING**  
INCORPORATED

1100 N. BEELINE HWY., SUITE B \* PAYSON, ARIZONA 85541 \* (520) 474-9646

PROJECT NO. 00-186

1983