

1846

2000 - 477

STATE OF ARIZONA
DEPARTMENT OF TRANSPORTATION
ENGINEERING SURVEY SERVICES



State of Arizona, County of Gila ss:
I do hereby certify that the within instrument was
filed and recorded at the request
of ADOT
Date 1-12-20 Time 9:45 M Map No. 1846
Official Records, Records of Gila County, Arizona WITNESS
my hand and official seal the day and year first above written.
Linda Haught Ortega
County Recorder
By Beverly J. Livingston Deputy

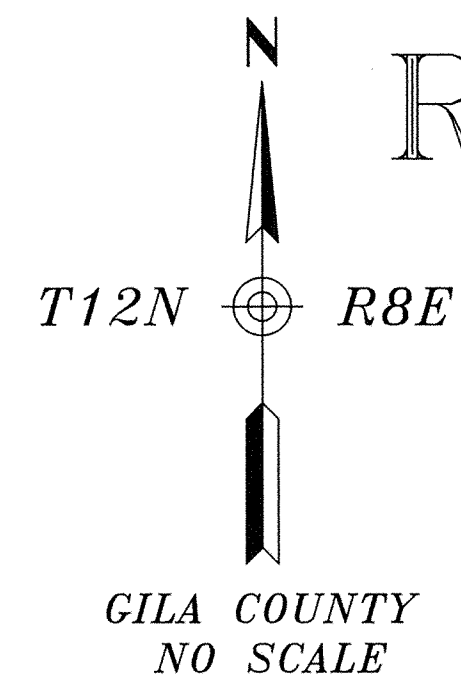
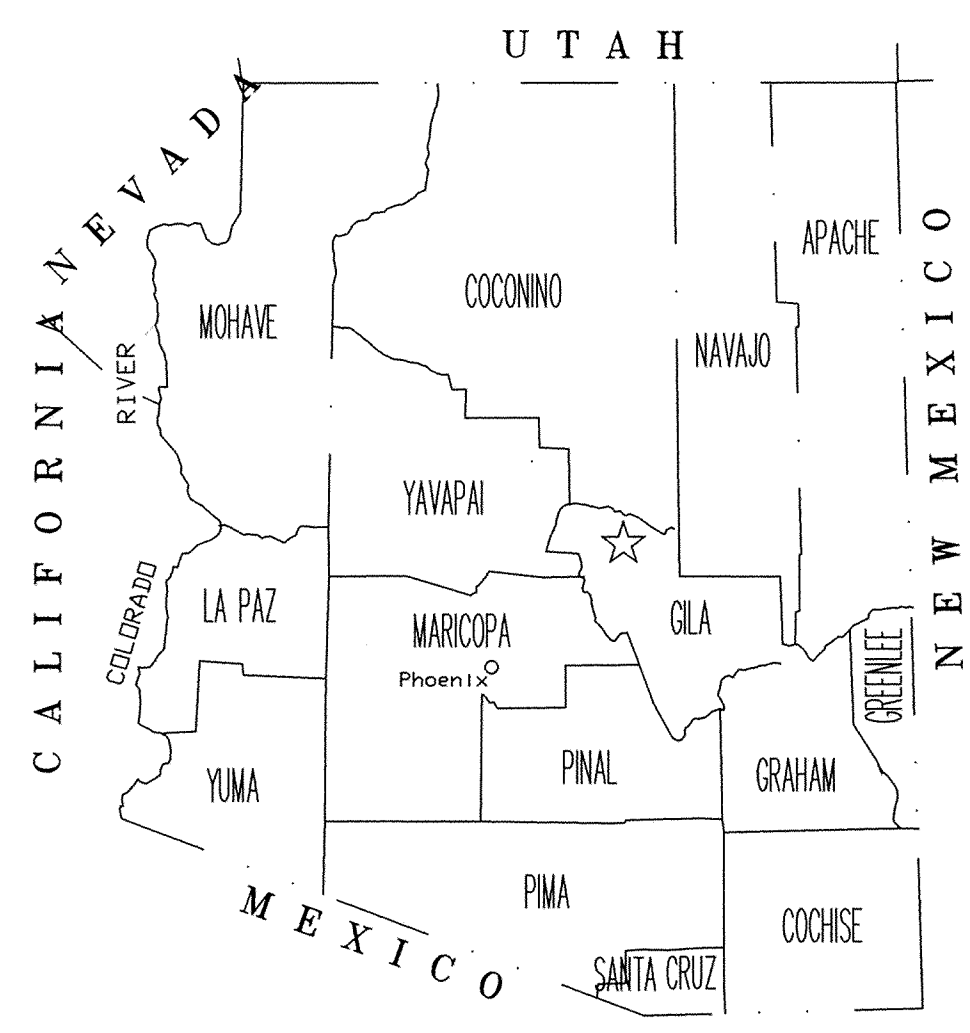

RECORD OF SURVEY
SR-87
Gila County

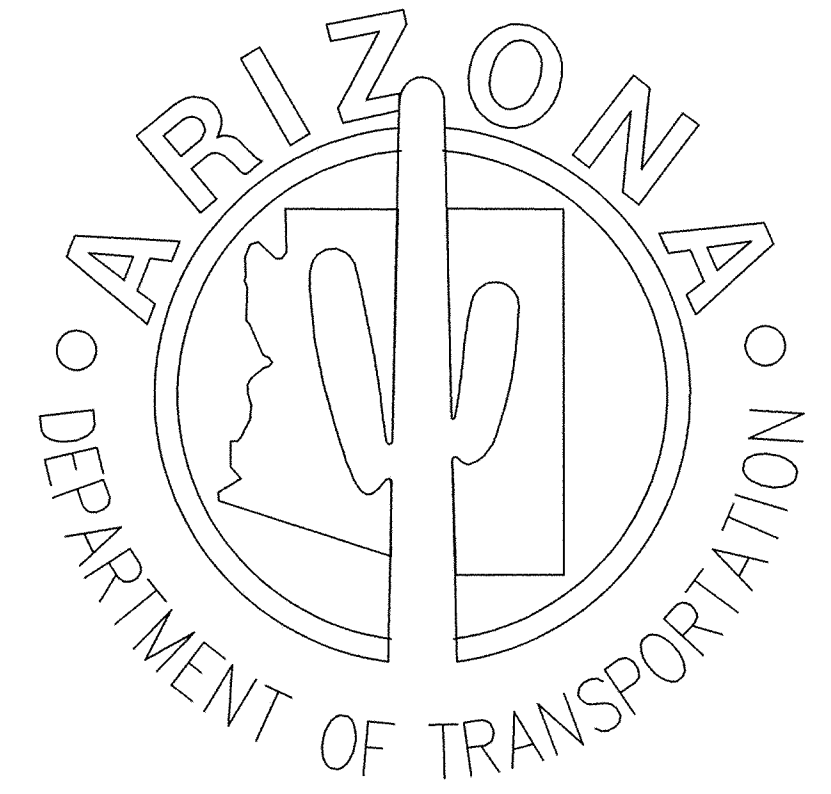

INDEX

- SHEET 1 COVER SHEET & RECORD TABLE
- SHEET 2 COORDINATE & CURVE TABLE
- SHEET 3 MAP

BASIS OF BEARING

The basis of bearings for this survey is N 24° 06' 40" W as measured between ADOT P&M triangulations stations Sycamore and Buck. Coordinate table values are based as follows.

Buck N = 1220883.127
E = 848459.120
Elev. = 5743.306

Sycamore
N = 1205897.562
E = 855247.551
Elev. = 5214.414

CERTIFICATION: I certify that this survey was performed under my direct supervision during the months of January, February and March of 1999 and meets the "Minimum Standards for Arizona Land Boundary Survey", as adopted by the State Board of Technical Registration in affect in October of 1998.

Jeffrey L. Andrews
Jeffrey L. Andrews, R.L.S. 12213

RECORD TABLE

- NOTE 1. AS RECORDED IN BOOK 55, PAGES 575-578 GILA COUNTY RECORDERS OFFICE; GLOBE, AZ.
- NOTE 2. PINE CREEK SUBDIVISION NO. 1 AS RECORDED IN BOOK 190, PAGE 124, GILA COUNTY RECORDERS OFFICE; GLOBE, AZ.
- NOTE 3. UNRECORDED ADOT MAP "SR-87" PAYSON-WINSLOW HIGHWAY PINE CREEK BRIDGE, GILA COUNTY. MP 267.3 TO MP 267.7, DATED DECEMBER 1984.
- NOTE 4. UNRECORDED ADOT RIGHT-OF-WAY PLANS. PAYSON-FLAGSTAFF STATE HIGHWAY PROJECT NO. 5-209-603 GILA COUNTY.

APPROVED TO RECORD

1/12/00
DATE

Jeffrey L. Andrews
GILA COUNTY COMMUNITY DEVELOPMENT DIVISION

DRAWING NO.	PINESR87.DWG	ARIZONA DEPARTMENT OF TRANSPORTATION
HARD COPY	JSD / 03-99	HIGHWAYS DIVISION
DRAWN/DATE	JSD / 03-99	ENGINEERING SURVEY SERVICES
CHECKED/DATE	JLA / 03-99	HIGHWAY SR-87 Pine
		PROJECT NO. 3-98018-12

A portion of the Northeastly Right of Way of SR-87 situated in the SE 1/4, NE 1/4 of Section 36, T12N,R8E, G&SR&M, Pine AZ.

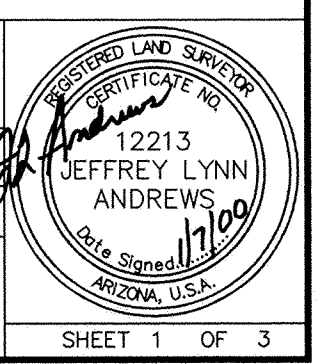

1846