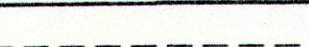
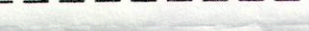

FEDERAL EMERGENCY  
MANAGEMENT AGENCY

CITY OF GLOBE  
AND GILA COUNTY  
FLOOD INSURANCE STUDY  
GILA COUNTY, ARIZONA

CONTRACT NO. EMF-1998-CO-0081

LEGEND

100-YR FLOODPLAIN BOUNDARY   
FLOODWAY BOUNDARY 

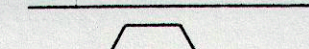
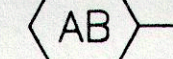
HYDRAULIC BASE LINE   
CROSS SECTION 

ELEVATION REFERENCE MARK  G-2

BASE FLOOD ELEVATIONS  1221  
ZONE DESIGNATIONS  ZONE AE

NOTES

- Vertical Datum Equation:  
NGVD1929 + 2.072 Ft.(0.6317 m) = NAVD1988.

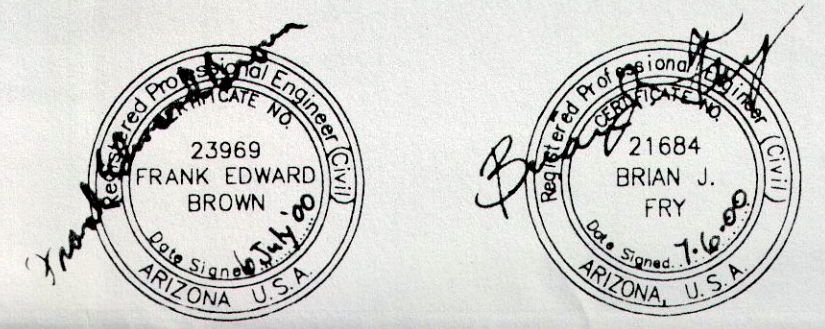
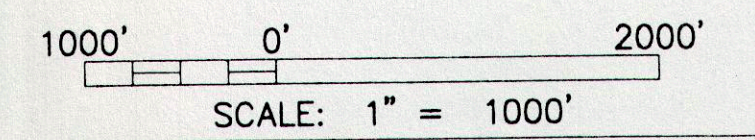

**D** **DIBBLE & ASSOCIATES**  
CONSULTING ENGINEERS  
Since 1962

DESIGN	BY	DATE	<b>FLOODPLAIN AND FLOODWAY WORK MAP</b>
DESIGN CHK.	BJF	11-99,6.00	
PLANS	BLJ	11-99	
PLANS CHK.	BJF	11,99,6.00	
SHEET			2 of 2

ELEVATION REFERENCE MARKS

NOTE: ALL ELEVATIONS ARE BASED ON NATIONAL  
GEODETIC VERTICAL DATUM OF 1929

REFERENCE MARK	ELEVATION (FT. NGVD)	DESCRIPTION OF LOCATION
RM-3G	3524.31	U.S. Coast and Geodetic survey brass cap in southwest stone face at the southeast corner of the old county courthouse building at the northwest corner of the intersection of Broad Street and Oak street.
RM-2G	3484.36	Extreme top of fire hydrant at the northeast corner of the intersection of Broad Street and Yuma Street. Established by U.S. Geological Survey.
RM-4G	3539.93	Extreme top of fire hydrant at the intersection of Ruiz Canyon Road and Jesse Hayes Street. Established by U.S. Geological Survey.
G-17	3746.55	Chiseled cross in top of concrete headwall wingwall, southeast side of U.S. Highway 60, approximately 20 feet below roadway level, about 2800 feet northeast of the intersection of U.S. Highway 60 and U.S. Highway 70.
G-18	3630.36	Arizona State Highway Department brass cap in bridge sidewalk, northeast side of U.S. Highway 80-70, about 100 feet northeast of the intersection of South Street and U.S. Highway 60-70. Stamped Station 21+30, Elevation 3631.13 1957.
G-19	3582.55	Chiseled cross in top of concrete headwall, right before it angles downward at culvert crossing into the Heritage Health Care Center, northeast side of 7th Street, about 100 feet southeast of the intersection of South Street and 7th Street.
G-20	3545.28	Chiseled cross in top of concrete headwall, at angle point with wing wall, northeast side of Highland Drive, northeast corner of the intersection of Carico Street/Fegan Street and Highland Drive.
G-21	3534.72	Chiseled cross in top of concrete headwall angle point, about 100 feet south of Carico Street and about 100 feet east of the Jesse Hayes Street bridge.
G-22	3589.63	Chiseled cross in top of concrete bridge sidewalk, northeast side of Pioneer Road, about 50 feet northwest of the intersection of Ice House Canyon/Six Shooter Canyon and Pioneer Road.
G-23	3633.25	Gila County brass cap in top of northwest curb of a bridge crossing the Icehouse Canyon stream channel, approximately 50 feet west of the intersection of Ice House Canyon and Albany Drive, about 0.5 miles south of the intersection of Six Shooter Canyon Road and Ice House Canyon Road. No stamps on cap.
G-24	3665.00	Chiseled cross in top of concrete bridge wingwall, southwest side of Pinal View, about 50 feet northwest of the intersection of Ice House Canyon Road and Pinal View, and about 0.8 miles south of the intersection of Ice House Canyon Road and Six Shooter Canyon Road.
G-25	3692.89	Gila County brass cap in top of north curb of a bridge on Alamo Way, about 50 feet west of the intersection of Ice House Canyon Road and Alamo Way, and about 1.0 miles south of the intersection of Ice House Canyon Road and Six Shooter Canyon Road. No stamps on cap.
G-26	3706.75	Chiseled cross in top of concrete headwall, south side of Adobe, about 50 feet west of the intersection of Adobe and Ice House Canyon Road, and about 1.1 miles south of the intersection of Ice House Canyon Road and Six Shooter Canyon Road.
G-27	3754.31	Chiseled cross in top of concrete bridge wingwall, north side of private driveway, about 250 feet west of Ice House Canyon Road, address of 8400 Ice House Canyon Road and about 1.55 miles south of the intersection of Ice House Canyon Road and Six Shooter Canyon Road.
G-28	3799.82	Gila County brass cap in concrete flush with asphalt road, south of the intersection of Kellner Canyon Road and Ice House Canyon Road, about 1.8 miles south of the intersection of Ice House Canyon Road and Six Shooter Canyon Road. No stamps on cap.
G-29	3847.83	Chiseled cross in top southwest corner of a 3 each by 6 foot culvert concrete headwall wing, south side of Kellner Canyon Road, about 2300 feet west of the intersection of Ice House Canyon Road and Kellner Canyon Road.
G-30	3617.95	Chiseled cross in top of southwest corner of concrete headwall, west side of Six Shooter Canyon Road, at the intersection of Cherokee Drive and Six Shooter Canyon Road, about 0.4 miles south of the intersection of Ice House Canyon Road and Six Shooter Canyon Road.
G-31	3631.72	Chiseled cross in top of concrete bridge curb, south side of Dickison Drive, southeast corner of the intersection of Six Shooter Canyon Road and Dickison Drive, about 1.6 miles south of the intersection of Six Shooter Canyon Road and Ice House Canyon Road.
G-32	3710.63	Chiseled cross in top of concrete bridge pier for steel bridge, northwest corner, north side of private drive-way, about 300 feet north of the intersection of Spur-lock Drive and Six Shooter Canyon Road, about 1.6 miles south of the intersection of Six Shooter Canyon Road and Ice House Canyon Road.
G-33	3740.82	Chiseled cross in top of concrete box culvert curb, west side of Six Shooter Canyon Road, about 1.85 miles south of the intersection of Ice House Canyon Road and Six Shooter Canyon Road.
G-34	3799.56	U.S. Department of Agriculture brass cap in top of concrete cattle guard headwall, west side of Six Shooter Canyon Road, at start of dirt road, about 2.4 miles south of the intersection of Six Shooter Canyon Road and Ice House Canyon Road.

NO.	STREET NAME
1	NAVAJO AV.
2	ACOMA AV.
3	TAOS AV.
4	MATLOCK AV.
5	BEER TREE CROSSING

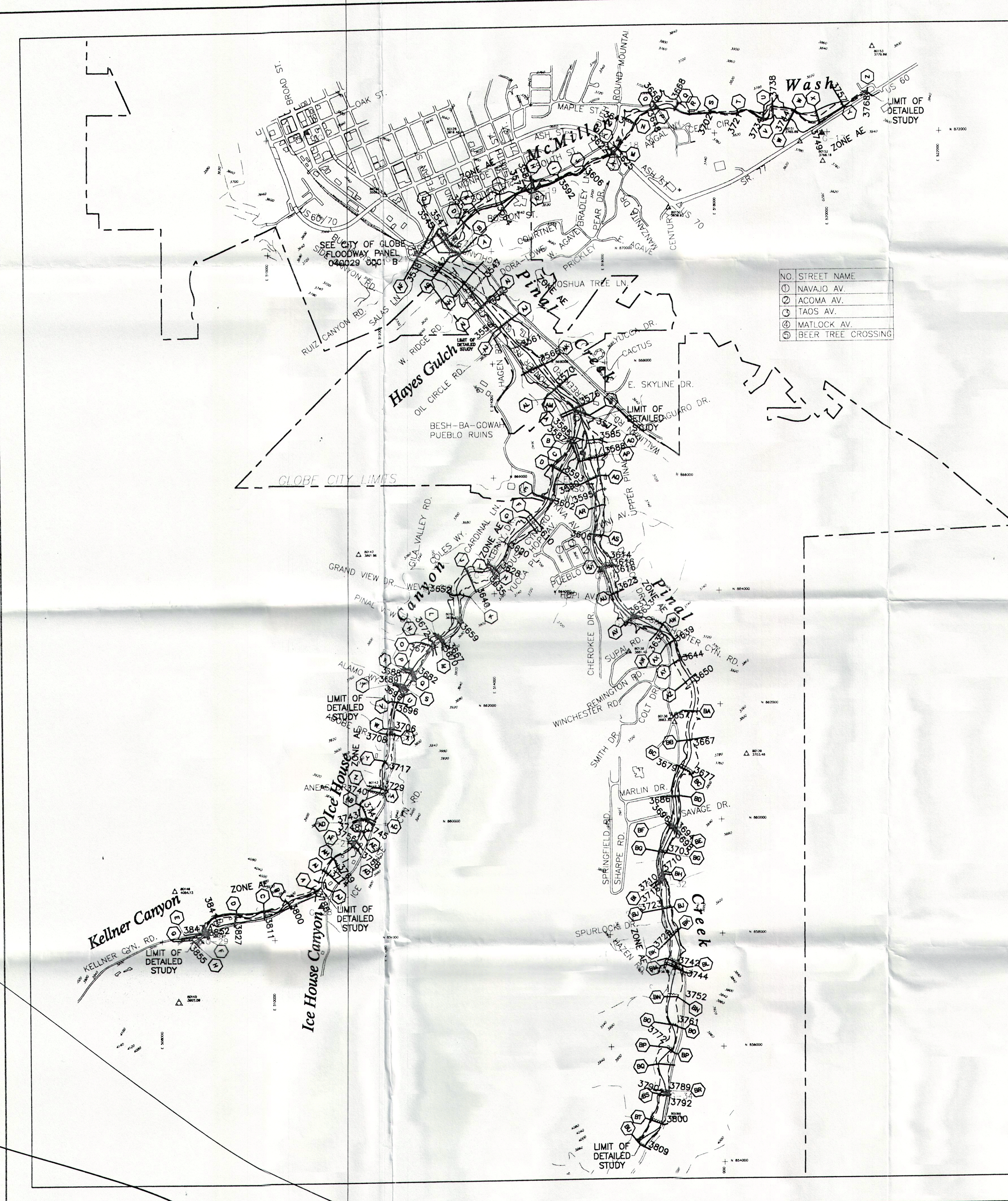

Source: 17-4823(2) (11/99) Date: 07/06/2000 11:04:18 Plot: 07/06/2000 11:04:18  
 Date: 07/06/2000 11:04:18 Plot: 07/06/2000 11:04:18  
 Date: 07/06/2000 11:04:18 Plot: 07/06/2000 11:04:18